

GLR100

TECHNICAL MANUAL

ENGLISH

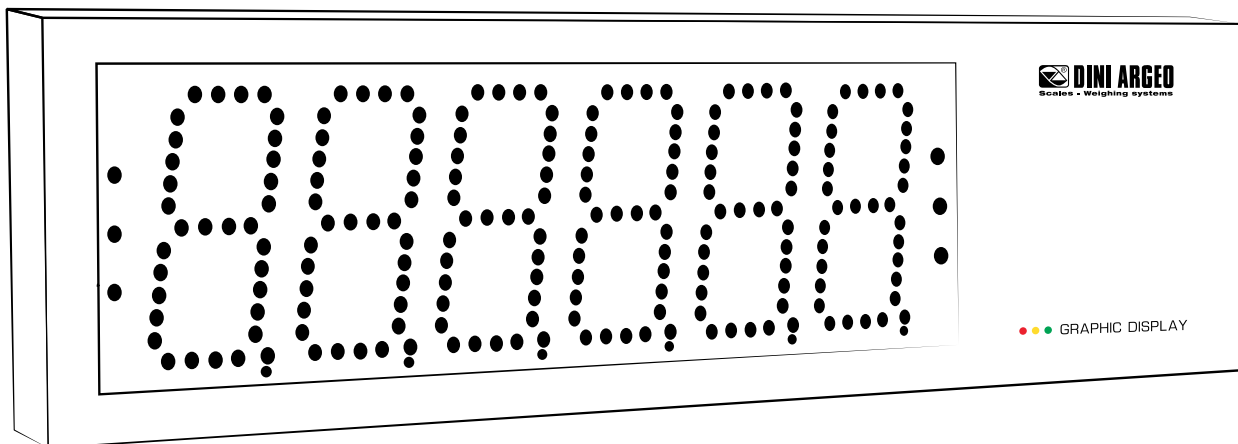

INDEX

Introduction

Warnings

Technical features

Installation

Connector wiring	5
Connection to instrument	5
Operating modes	5
Indicator configuration 3590 Touch screen	6
Indicator configuration 3590E	7
Customisation of the displayed messages, for indicators 3590EGT/E	7
Indicator configuration DFW	8
Indicator configuration DGT	8

Introduction

The purpose of this manual is to familiarise the user with the different operating modes of the weight repeater and the configuration procedure.

We recommend carefully following the instructions when programming the weight repeater; performing actions not indicated in this manual, could jeopardise proper instrument operation.

Depending on the instrument connected, it is possible to display the weight up to 3 different colours: red, green and yellow. Data is transmitted via 485 or radio communication, depending on the model.

This manual was written with the utmost care but we always welcome feedback on any inaccuracies you may find.

Warnings

The instrument is covered by warranty and **MUST NOT BE OPENED BY THE USER** for any reason. Any attempt to repair or modify the unit could expose the user to the risk of electrical shock and will render all warranty conditions null.

All problems with the unit or the system must be communicated to the manufacturer or the dealer from which it was purchased. In any case, **DISCONNECT POWER** before any operations.

The instrument is insulated between the dangerous voltage area and the parts that are accessible to the user.

- Do not pour liquids onto the repeater.
- Do not use solvents to clean the repeater.
- Do not expose the instrument to direct sunlight or sources of heat.
- Set or secure the indicator and the platform on a base with no vibrations.
- All the indicator connections must be made respecting the applicable standards in the installation area and environment.

Whatever is not explicitly described in this manual is to be considered improper use of the equipment.

Do not install in atmospheres with the risk of explosion.



The crossed out wheeled bin symbol on the product shows that it must be brought to appropriate separate waste collection centres at the end of its life cycle or returned to the dealer when purchasing a new equivalent product. Proper separate collection to then send the product to recycling contributes to preventing possible negative effects on the environment and to health and promotes recycling. Users who dispose of the product illegally shall face administrative sanctions as provided for by law.

Technical features

Display	RGB LED matrix Panel Display, 600 x 150 mm
Keyboard	6 digits of 110 mm or 2 42 mm high lines of 16 characters . 3 colours (red, yellow, green)
Communication	RS485 / Radiofrequency communication (depending on the model)
Baud Rate	9600 n-8-1
Case	Painted steel
Protection rating	IP54
External dimensions	835 x 190 x 50 mm
Power supply	100 - 240 VAC 50 / 60 Hz

Connector wiring

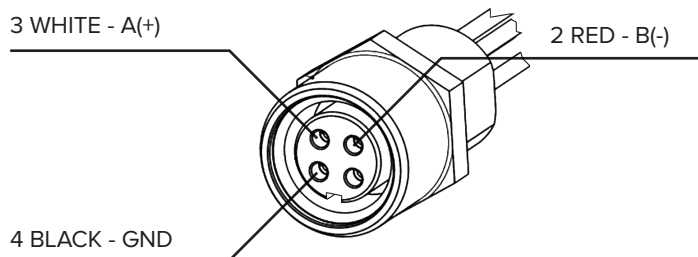

Check that the expansion for RS485 communication is present on the indicator. Consult the technical manual of reference.

Connection to instrument

	RS485			RADIOFREQUENCY		
	WHITE	RED	BLACK	YELLOW	PINK	BLACK
DGT	A(+)	B(-)	GND	RX	TX	GND
DFW	A(+)	B(-)	GND	COM1		
3590E / 3590 Touch screen	A(+)	B(-)	GND	COM3		

Operating modes

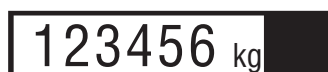

NUMERIC



ALPHANUMERIC



CUSTOMISED
MESSAGES



Depending on the connected instrument, it is possible to dynamically change the display colour under pre-established conditions, such as reaching of the weight threshold or weighing cycle end. If permitted by the connected indicator, by assigning a 485 address to multiple repeaters, it is possible to simultaneously display different texts and messages.

	NUMERIC	ALPHANUMERIC	CUSTOMISED MESSAGES	ADDRESSING 485	DISPLAY COLOUR			
					RED	YELLOW	GREEN	DYNAMIC
DGT	•				•			
DFW	•				•			
3590E	•		•		•	•	•	
3590 Touch screen	•	•	•	•	•	•	•	•

Indicator configuration 3590 Touch screen

Numerical display

1.

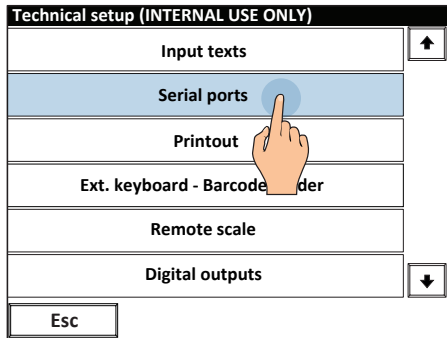

2.

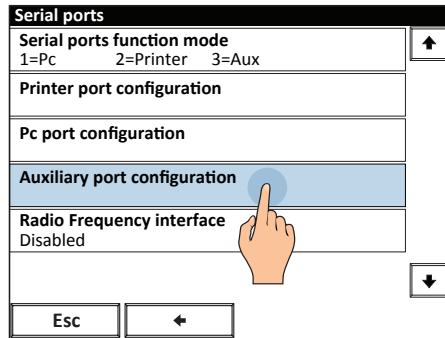

3.

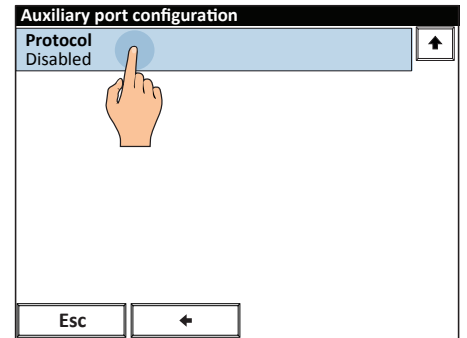

4.

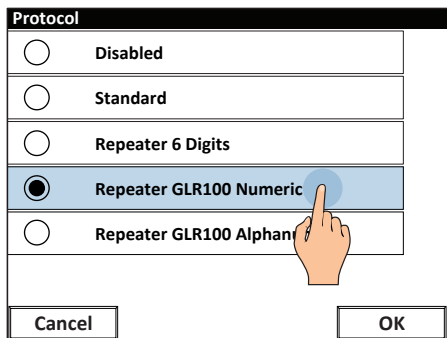

5. **485 Address assignment:** after setting the type of protocol, it is possible to assign a 485 address to the repeater.

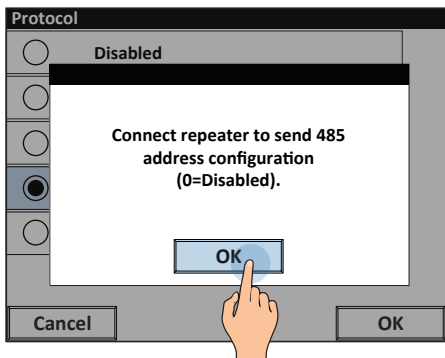

6.

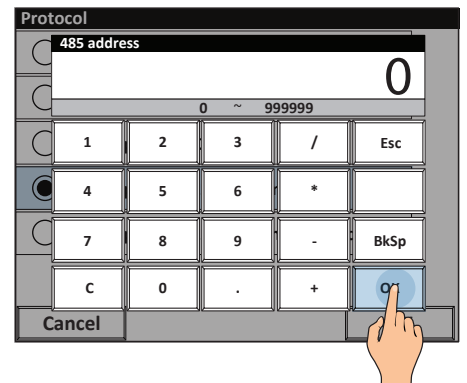

Alphanumeric display

1.

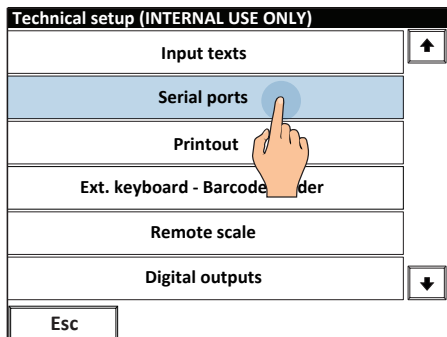

2.

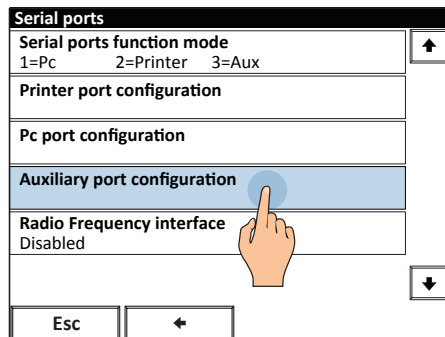

3.

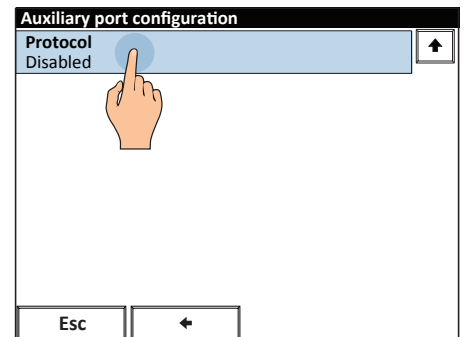

4.

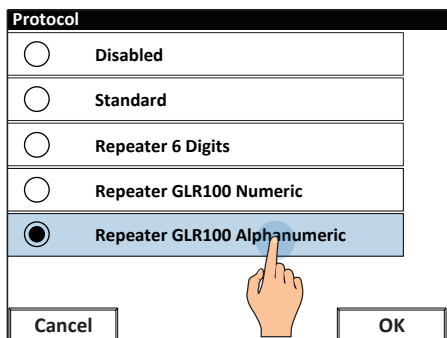

5. **485 Address assignment:** after setting the type of protocol, it is possible to assign a 485 address to the repeater.

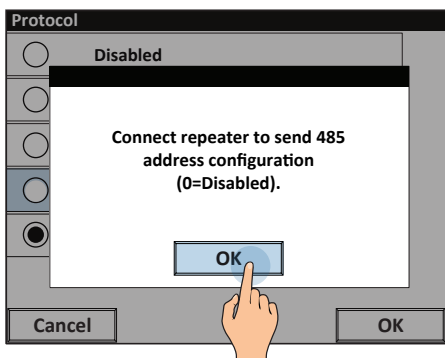

6.

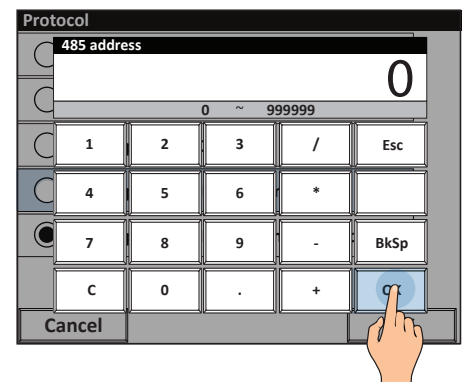

Assign address 0 to disable the 485 addressing.
If the 485 address is enabled, it is necessary to customise the communication string (print format 100) with Dinitools.

Indicator configuration 3590E

Numerical display



Customisation of the displayed messages, for indicators 3590EGT/E

Access the Dinitools standard database and send one of the available example configurations. Alternative, modify the string described in the following table.

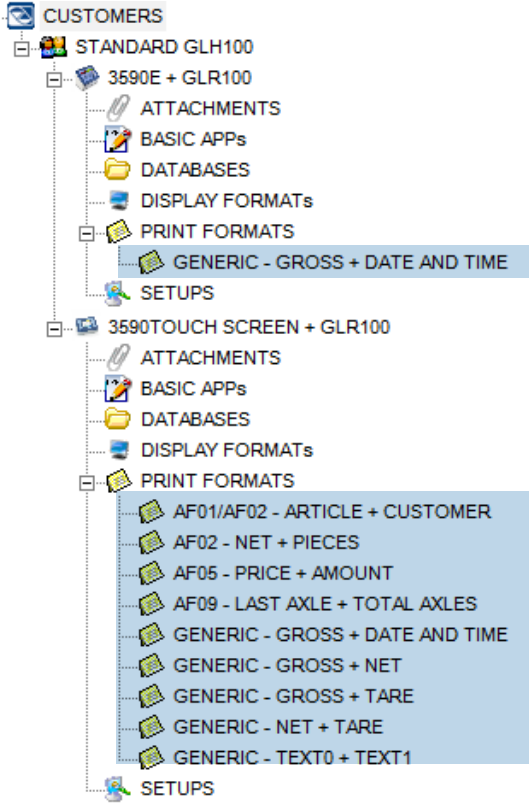

The following table features an example of the structure of the string to be sent, divided by parameter:

[0]	[1]	0	1	2	3	4	5	6	7	8	9	10	11	12	13	14	15	16	17	18	19	20	21	22	23	24	25	26	27	28	29	30	31	32	33	34	35	36	
0	1	N	E	T							1	0	0	0	0	k	g	,	G	R	O	S	S					1	2	0	0	0	0	k	g	,	R	CR	LF

Address 485 (2 Characters, optional)

0	1
---	---

First line (16 characters)

N	E	T									1	0	0	0	0	k	g
---	---	---	--	--	--	--	--	--	--	--	---	---	---	---	---	---	---

Second line (16 characters)

G	R	O	S	S							1	2	0	0	0	k	g
---	---	---	---	---	--	--	--	--	--	--	---	---	---	---	---	---	---

Colour (1 character - R = red, Y = yellow, G = Green)

On 3590 Touch screen, in order to use the dynamic colouring, use the print macro @[353;200].

R

Terminator (2 characters - Use terminator [CR][LF])

CR	LF
----	----

Indicator configuration DFW

Set if the firmware version is $\geq 04.xx$



Set if the firmware version is $\leq 03.xx$



Indicator configuration DGT

RS485 communication

Set:



Radio communication

Set:



Multiple horizontal lines for taking notes.

This publication, or portions thereof, may not be duplicated without written permission from the Manufacturer. All information contained in this manual is based on the data available at the time of its publication; the Manufacturer reserves the right to make changes to its products at any time without notice and without incurring any penalty. We therefore recommend that you always check for any updates.

The individual in charge of the scale operation must ensure that all safety regulations in force in the country of use are applied, ensuring that the appliance is used in accordance with the purpose it is intended for and to avoid any danger for the user.

The Manufacturer declines any liability arising from any weighing operation errors.



HEAD OFFICE

Via Della Fisica, 20
41042 Spezzano di Fiorano, Modena - Italy
Tel. +39 0536 843418 - Fax +39 0536 843521

SERVICE ASSISTANCE

Via Dell'Elettronica, 15
41042 Spezzano di Fiorano, Modena - Italy
Tel. +39 0536 921784 - Fax +39 0536 926654

www.diniargeo.com

Authorised service centre stamp

